

Jack for soft plug for surface mounting

BM series

- This jack can be fit to a surface mounting board.
- This jack is adaptive for the soft plug (BJ series) .
- This is used for checking of a PC board, etc.
- Material: Brass



■ Part No.

Part No.	Finish	Package	Adaptive plug
BM-2-11-G	Gold plating over nickel base	Bulk (100pcs/pack)	BJ-2 series
BM-2-11-G-T	Gold plating over nickel base	Reel (500pcs/reel)	BJ-2 series
BM-2-11-S	Tin plating over nickel base	Bulk (100pcs/pack)	BJ-2 series
BM-2-11-S-T	Tin plating over nickel base	Reel (500pcs/reel)	BJ-2 series
BM-4-17-G	Gold plating over nickel base	Bulk (100pcs/pack)	BJ-4 series
BM-4-17-S	Tin plating over nickel base	Bulk (100pcs/pack)	BJ-4 series

■ Example of usage

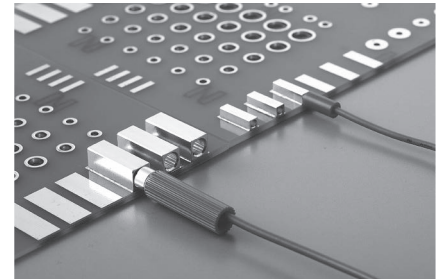

When BN series is used

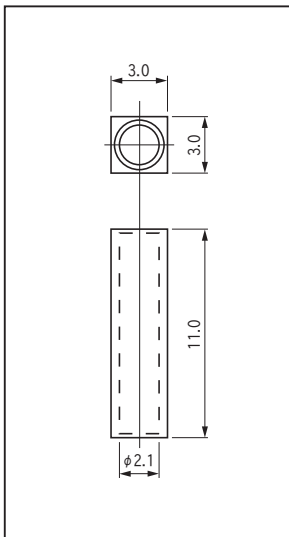

BM-2-11

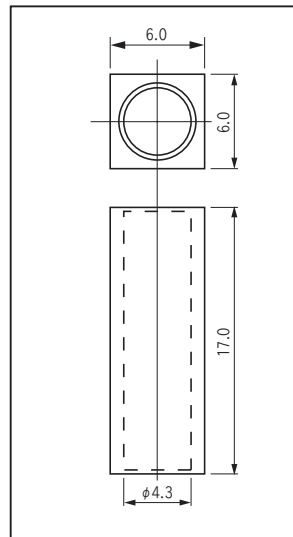

BM-4-17

■ Recommended land information

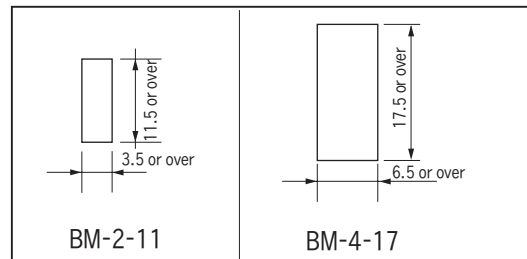

■ BM-2-11-G-T, BM-2-11-S-T

