

Test point for logic

ST series (1000pcs/pack)

- Best solution for a logic circuit.
- This terminal can be inserted in a hole of ϕ 0.5, ϕ 0.6, ϕ 0.8, ϕ 1.0 and ϕ 1.2
- This terminal can be fit to a through hole land for upper and lower electrical connection.
- Material: Brass
- Finish: Gold plating over nickel base

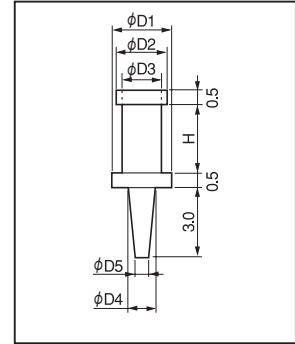
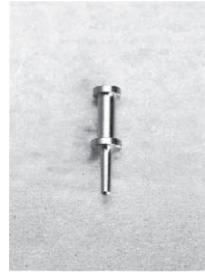

■ Table of dimensions

Part No.	D ₁	D ₂	D ₃	D ₄	D ₅	H	Printed board fitting hole diameter
ST-1-1	2.0	1.8	1.2	0.8	0.65	3.0	ϕ 0.8
ST-1-2	2.0	1.8	1.2	0.8	0.65	6.0	ϕ 0.8
ST-1-3	2.0	1.8	1.2	0.8	0.65	10.0	ϕ 0.8
ST-2-1	2.5	2.2	1.4	1.0	0.8	3.5	ϕ 1.0
ST-2-2	2.5	2.2	1.4	1.0	0.8	6.5	ϕ 1.0
ST-2-3	2.5	2.2	1.4	1.0	0.8	10.5	ϕ 1.0
ST-3-1	2.5	2.2	1.4	1.2	1.0	3.5	ϕ 1.2
ST-3-2	2.5	2.2	1.4	1.2	1.0	6.5	ϕ 1.2
ST-3-3	2.5	2.2	1.4	1.2	1.0	10.5	ϕ 1.2
ST-4-1	1.5	1.5	1.0	0.8	0.65	3.0	ϕ 0.8
ST-4-2	1.5	1.5	1.0	0.8	0.65	5.0	ϕ 0.8
ST-5-1	1.2	1.2	0.8	0.6	0.5	3.0	ϕ 0.6
ST-5-2	1.2	1.2	0.8	0.6	0.5	5.0	ϕ 0.6
ST-6-1	1.0	1.0	0.7	0.5	0.4	3.0	ϕ 0.5
ST-6-2	1.0	1.0	0.7	0.5	0.4	5.0	ϕ 0.5

Test point for logic For printed board with a thickness of t3.2

SB series (1000pcs/pack)

- This is a test point to be used for a PC board with a thickness of t3.2
- Material: Brass
- Finish: Gold plating over nickel base

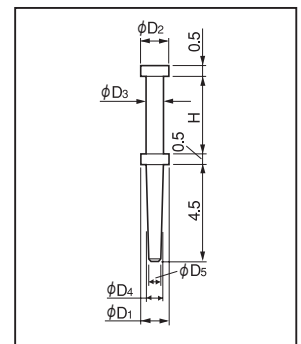
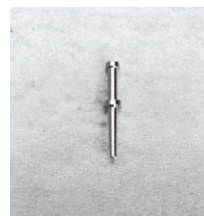

■ Table of dimensions

Part No.	D ₁	D ₂	D ₃	D ₄	D ₅	H	Printed board fitting hole diameter
SB-1-1	1.5	1.2	0.8	0.8	0.65	3.0	ϕ 0.8
SB-1-2	1.5	1.2	0.8	0.8	0.65	5.0	ϕ 0.8
SB-2-1	2.0	1.5	1.0	1.0	0.8	3.5	ϕ 1.0
SB-2-2	2.0	1.5	1.0	1.0	0.8	6.5	ϕ 1.0