

LED socket (square shape)

LQR-4-5 Series

- This socket is used for a square-shaped LED.
- This is used for storing in a pipe, etc. for use.
- The type with electric wire is also available.
- Material
 - Resin part: PPS black (UL94V-0)
 - Socket part Body: Brass
 - Contact: Beryllium copper
 - Finish: Gold plating over nickel base
- Rated current: 3A (without electric wire)
- Rated voltage: 125V AC, DC
- Contact resistance: 10 m Ω or less (per pin)
- Insulation resistance: 500 M Ω or over
- Withstand voltage: 1000V AC, DC per minute
- Insertion / removal durability : 100 cycles
- Insertion / removal forces: 70g or over (per pin)
- Operating temperature range: - 40 to + 125 °C (without electric wire)
- Adaptive male pin diameter: φ 0.6 to φ 0.8
 - 0.5 to □0.64
 - 0.4 × 0.76



■ Example of usage



■ Part No.

LQR-4-5(10pcs/pack)

■ Part number of the type with electric wire

LQR-4-5-W(1pcs/pack)

■ Dimension

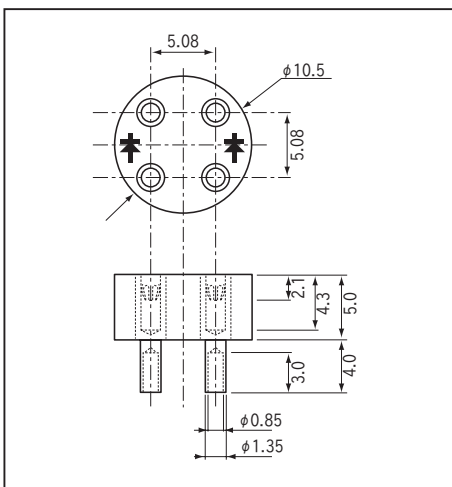

■ Type with electric wire (Part No.: LQR-4-5-W)

