

Pin for coaxial cable installation

Part No.: **CC-1-1, CC-1-2** (1000pcs/pack)

- This pin is used for soldering a coaxial cable to a connector leg.
- If the coaxial cable core wire is directly soldered to the connector leg, it may be broken. If this pin is used, such breakage will be prevented and the work efficiency will be further improved.
- Material: Phosphor bronze t0.3
- Finish: Tin plating over nickel base
- Adaptive connector leg: □0.64
- Adaptive coaxial cable: 1.5C-2V (CC-1-1)
: Thinner than ϕ 2.2 (CC-1-2)

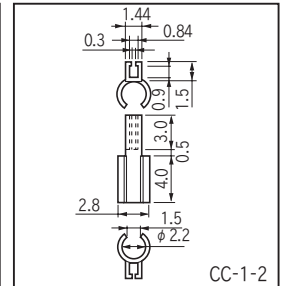
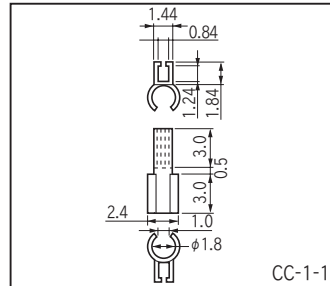
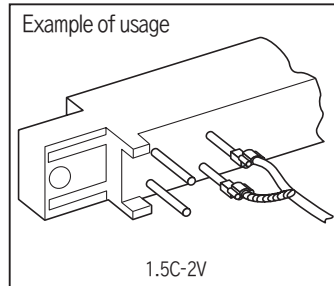

■ Part No.:

CC-1-1, CC-1-2

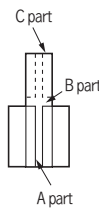

● How to use

- (1) Insert the coaxial cable to the A part and press it down with pliers to fix.
- (2) Wind the core wire around B part once.
- (3) Insert the C part to the connector leg and solder it with the B part.
- (4) Perform the same procedures for the shield side. (Winding around the B part is not required.)

Pin for reinforcing coaxial cable

Part No.: **CC-2-1** (1000pcs/pack)

- If a coaxial cable is directly inserted to a PC board and soldered, an accident of broken core wire will occur.
- By using this product, such accident of breakage will be prevented.
- Material: Phosphor bronze t0.4
- Finish: Tin plating over nickel base
- Printed board fitting hole diameter: ϕ 0.8
- Adaptive coaxial cable: 1.5C-2V

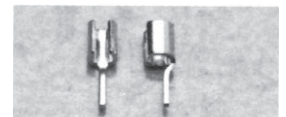

■ Part No.: CC-2-1

■ How to use

Flatten the \sqsupset -shaped part with pliers and fix the covering part.
Please insert the core wire together with the pin in the through hole and perform soldering.

